



## Main

Range of Product	Altivar
Accessory / separate part category	Mounting and fixing accessory
Accessory / Separate Part Type	Mounting kit
Accessory / separate part destination	Variable speed drive
Range Compatibility	Altivar 71 Altivar 71Q Altivar 32 Altivar 61 Altivar 212 Altivar 61Q Altivar Machine ATV320
IP Degree of Protection	IP54

## Complementary

Kit composition	Screws and bolts for mounting Mounting hardware
Net Weight	0.33 lb(US) (0.15 kg)

## Ordering and shipping details

Category	22135-ATV61-71 ACCESSORIES
Discount Schedule	CP4C
GTIN	3389118069312
Returnability	Yes
Country of origin	FR

## Packing Units

Unit Type of Package 1	PCE
Number of Units in Package 1	1
Package 1 Height	2.95 in (7.500 cm)
Package 1 Width	6.50 in (16.500 cm)
Package 1 Length	9.06 in (23.000 cm)
Package 1 Weight	7.83 oz (222.000 g)
Unit Type of Package 2	S03
Number of Units in Package 2	7
Package 2 Height	11.81 in (30.000 cm)
Package 2 Width	11.81 in (30.000 cm)
Package 2 Length	15.75 in (40.000 cm)
Package 2 Weight	4.49 lb(US) (2.037 kg)
Unit Type of Package 3	P06
Number of Units in Package 3	56
Package 3 Height	29.53 in (75.000 cm)
Package 3 Width	23.62 in (60.000 cm)
Package 3 Length	31.50 in (80.000 cm)
Package 3 Weight	58.72 lb(US) (26.636 kg)

## Offer Sustainability

California proposition 65	WARNING: This product can expose you to chemicals including: Lead and lead compounds, which is known to the State of California to cause cancer and birth defects or other reproductive harm. For more information go to <a href="http://www.P65Warnings.ca.gov">www.P65Warnings.ca.gov</a>
REACH Regulation	<a href="#">REACH Declaration</a>
REACH free of SVHC	Yes
EU RoHS Directive	Pro-active compliance (Product out of EU RoHS legal scope) <a href="#">EU RoHS Declaration</a>
Toxic heavy metal free	Yes
Mercury free	Yes
China RoHS Regulation	<a href="#">China RoHS Declaration</a>
RoHS exemption information	<a href="#">Yes</a>

## Contractual warranty

Warranty	18 months
----------	-----------

Door Mounting Kit for Remote Graphic Display Terminal

Dimensions and Mounting

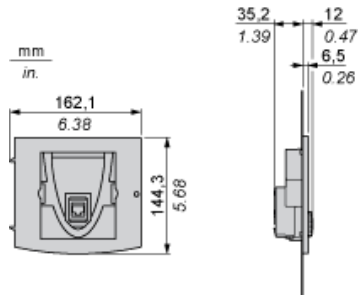

Cuts-outs and drill holes

