

8	7	6	5	4	3	2	1		
MODEL NO.	"HL"	"L"	"D"	P/N	MODEL NO.	"HL"	"L"	"D"	P/N
IAI.53SMTAM600	1.38	36	.090	21568	IAI3SMTAM2.75	2.75	36	.062	21756
IA.754SMTA	1.38	48	.046	21494	IAI.62SMTA	1.38	24	.100	21752
IAI.58SMTA	1.38	96	.090	21479	IAI.53SMTAM2	2.00	36	.090	21662
IAI.52SMTA	1.38	24	.090	21423	IAI.520SMTA	1.38	240	.090	21636
IAI.55SMTA	1.38	60	.090	21424	IAI.53SMTAM3	3.00	36	.090	21573
IAI.56SMTA	1.38	72	.090	21427	IAI.39SMTAMCT	1.38	4.7 ±.1	.062	21572
IA.753SMTA	1.38	36	.046	21158					
IAI3SMTA	1.38	36	.062	21196					
IAI5SMTA	1.38	60	.062	21173					
IAI.54SMTA	1.38	48	.090	21223					
IAI.57SMTA	1.38	84	.090	21035					
IAI.53SMTA	1.38	36	.090	21056					

MODEL NO.	"HL"	"L"	"D"	P/N
IAI3SMTAM2.75	2.75	36	.062	21756
IAI.62SMTA	1.38	24	.100	21752
IAI.53SMTAM2	2.00	36	.090	21662
IAI.520SMTA	1.38	240	.090	21636
IAI.53SMTAM3	3.00	36	.090	21573
IAI.39SMTAMCT	1.38	4.7 ±.1	.062	21572

NOTES:

- 'M600' SUFFIX INDICATES THAT FIBERS POTTED ON ANGLED END WITH EPOXY THAT OPERATES IN MAX. TEMPERATURE OF 600°F.

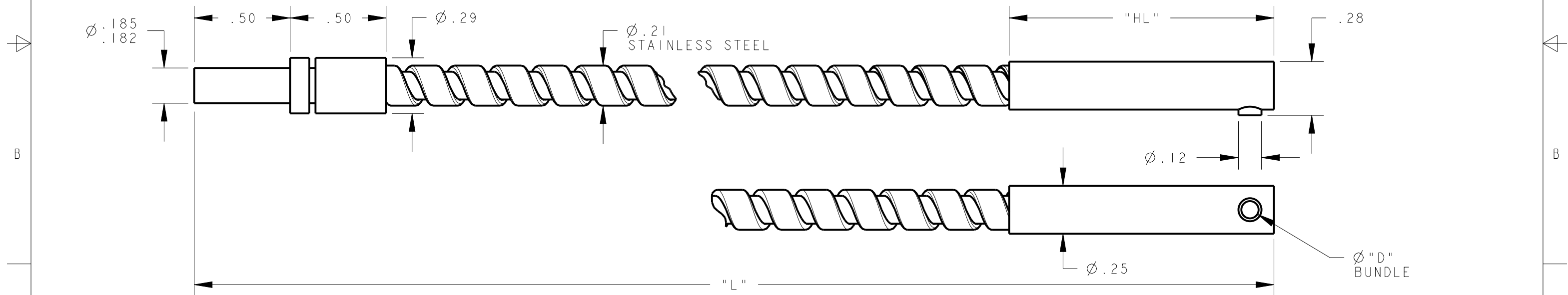

- NOTES:
- ALL DIMENSIONS ARE MILLIMETERS [INCHES] UNLESS OTHERWISE NOTED.
 - REFER TO "www.bannerengineering.com" FOR ADDITIONAL DATA AND SPECIFICATIONS.

This drawing is the property of BANNER ENGINEERING CORP. Any use or reproduction, in any form, without prior written permission of Banner is prohibited. © 2015 Banner Engineering Corp.

THIRD ANGLE PROJECTION

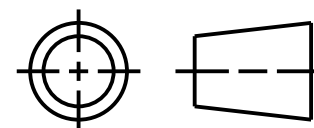

		BANNER ENGINEERING CORP.	
		www.bannerengineering.com	
TITLE			
IAI.5 SERIES SS TIGHT ANGLE			
SIZE	DRAWING NO.	REV.	
B	161915	A	
SCALE	SHEET		CREO
2:1	1 OF 2		

