

SHAFT DETAIL (NO SCALE)

PIN-OUT		
ENCODER CONNECTOR		
PIN	FUNCTION	COLOR
1-6	-	-
7	EPWR	RED
8	ECOM + BAT-	BROWN/BLACK + BLACK
9	SHIELD	BLACK SHRINK
10-11	-	-
12	SD+	BLUE
13	SD-	BLUE/BLACK
14	BAT+	BROWN
15	-	-

PIN-OUT		
POWER CONNECTOR		
PIN	FUNCTION	COLOR
1	U	RED
2	V	WHITE
3	W	BLACK
4	GROUND	YELLOW/GREEN

- SPECIFICATIONS:
- MOTOR TYPE: 8 POLE, 3 PHASE, WYE WINDING, PERMANENT MAGNET ROTOR, TOTALLY ENCLOSED, NON VENTILATED.
 - CONTINUOUS STALL TORQUE: 0.181 Nm (1.60 LB-IN) MAX AT 125°C WINDING TEMPERATURE, IN A 40°C AMBIENT, WHEN MOUNTED ON AN 8 INCH SQUARE X 1/4 INCH THICK ALUMINUM HEAT SINK.
 - OPERATING SPEED: 5000 RPM MAX.
 - Ke: 25±10% V/KRPM 0-PEAK (PHASE TO PHASE) AT 20-30°C.
 - SERIAL ENCODER, WITH 16 BIT MULTI-TURN AND 17 BIT SINGLE TURN ABSOLUTE POSITION DATA.
 - FOR ADDITIONAL SPECIFICATIONS SEE TLA120PBJ32AAESE.

POWER CONNECTOR
 AMP 350779-1 HOUSING
 AMP 350218-3 PIN CONTACTS (U,V,W)
 AMP 350654-1 PIN CONTACT (GROUND)

ENCODER CONNECTOR
 AMP 172171-1
 AMP 770835-1 PIN CONTACTS

01	1007016	SJ	RELEASED	-	-
REV	ECN	BY	REVISION DESCRIPTION	DATE	CHKR
UNLESS OTHERWISE SPECIFIED			DRAWN BY	DATE	DESIGN ENGR
DO NOT SCALE DRAWING			SJ	3-09-04	-
DIMENSIONS ARE IN MILLIMETERS			TL-A120P-BJ32AA,ESM		
WITH INCHES REFERENCED [X.X]					
UNTOLERANCED DIMENSIONS ARE REFERENCE					
THIRD ANGLE PROJECTION					

ProE Version 0 Modified 0

DXF FILE AVAILABLE

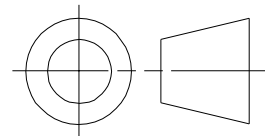

PART NO. TLA120PBJ32AAESM		
SCALE : 1 1.000	DWG SIZE B	SHEET 1 OF 1